

INSTALLATION INSTRUCTIONS FOR QUICK-STEP VINYL FUSE AND PRISTINE

TO OBTAIN THE BEST RESULT, THE INSTALLATION INSTRUCTIONS MUST BE CAREFULLY FOLLOWED BY ALL PARTIES.

Please make sure that the end user of the flooring has a copy of this document.

Please check with your local building authority regarding floor application and suitability.

- Site and installation conditions must always comply with the relevant national and state regulations and installation standards.
- In case the national and state regulations conflict with the manufacturer's recommendations, the most stringent of the two prevails.

1. PREPARATION

We recommend to order all boxes for the same commercial flooring project at the same time.

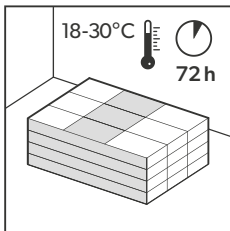

1

Always store and transport Quick-Step Vinyl floors carefully to prevent distortions. Store and transport the boxes on a flat surface in neat stacks. Never store the boxes upright or in moist or in dusty rooms. Do not store the boxes in very cold ($< 5^{\circ}\text{C}$) or very warm ($> 35^{\circ}\text{C}$) or in humid places. Quick-Step Vinyl floors must be acclimatised in the room of installation between 18-30°C for a period of at least 48 hours before installation. This floor & room temperature needs to be maintained prior to, during and for at least 72 hours after the installation is completed.

Install your floor between 18 and 30°C and a subfloor temperature of above 15°C.

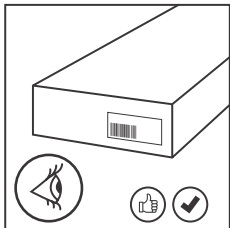

2

Quick-Step Vinyl floors can be bought in different formats, decors and qualities. Make sure you have received the correct flooring that you ordered before starting the installation.

Note: It is always a good idea to store the end labels together with your purchasing receipt.

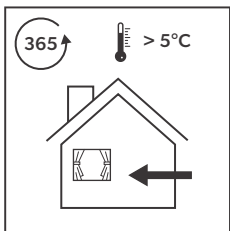

3

Quick-Step Vinyl has been designed for indoor heated ($> 5^{\circ}\text{C}$) installations, preferably at normal room temperature ($\approx 18-30^{\circ}\text{C}$). Quick-Step Vinyl cannot be installed in solariums, seasonal porches, camping trailers, boats or any other unheated application.

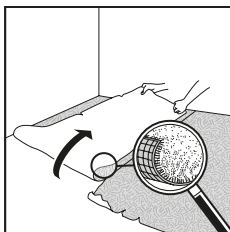

4

The type of subfloor, its quality and its preparation has a big influence on the final installation result. If the subfloor is not appropriate for the installation of Quick-Step Vinyl then necessary actions should be taken. Contact your Quick-Step Vinyl dealer, who will be more than happy to advise you.

Be aware that unevenness in the subfloor may leave marks and can create gaps in your Quick-Step Vinyl floor.

The subfloor should be stable and firmly fixed in accordance with Australian Standards AS1884:2021.

Furthermore it cannot be soft, damaged or loose laid. Remove existing and/or too soft floorcoverings such as but not limited to carpet, needle felt, cushion vinyl. Floating floor coverings also need to be removed.

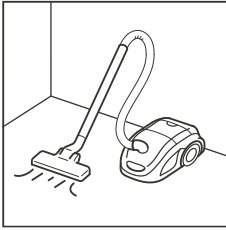

5

The subfloor must be hard, self-supporting, structurally sound, flat, smooth, clean and permanently dry, as well as being free from defects and fit for purpose. When required, scrape off and remove old adhesives and loose laying levelling compound.

Make sure the subfloor is free from grease, chemical substances and other contamination. Prior to installation, carefully remove all debris (including nails), sweep and vacuum. Repair major surface imperfections and large cracks.

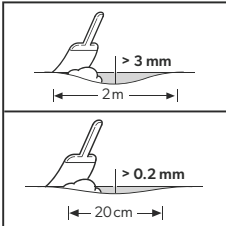

6

Any unevenness of more than 0.2mm over a length of 20cm must be levelled out.

The same applies to unevennesses of more than 3mm over a length of 2m.

After testing the subfloor moisture, use an appropriate levelling compound and check if a primer or sealer is needed. Grout lines between tiles or other gaps of more than 0.2mm should be levelled.

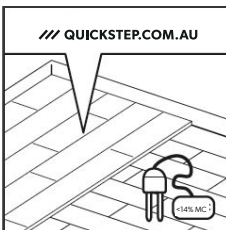
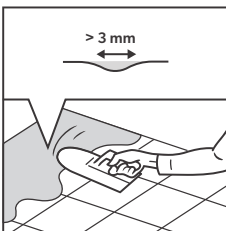
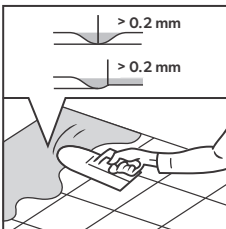

7

In case of installation on a wooden subfloor, please remove any existing floor covering first.

No signs of mould and/or insect infestations should be present.

If there is high moisture in the woodbased subfloor or there is no proper moisture barrier below the woodbased subfloor, it has to be removed first. If this is not done, the wood will rot when covered with the Quick-Step Vinyl flooring, which is impervious. The moisture will not be able to evaporate through the floor covering. Make sure the subfloor is level and nail or screw down any loose parts. Apply a suitable wooden floor panel, level floor, or use levelling compound on top for a perfect subfloor preparation. The levelling boards must be fixed in accordance with AS1884:2021. Any crawl space or void below the plank floor must be sufficiently ventilated. In case there is no crawl space, make sure that the moisture content of all the floor layers (wooden subfloor + subfloor (for ex. cement screed, anhydrite, etc.)) are lower than the mentioned values. Remove any obstacles and make sure there is sufficient ventilation (minimum 4 cm² total ventilation openings per m² of floor).

The moisture content of the wood must not exceed 14%.

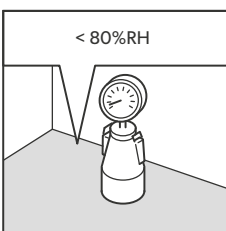

8

The moisture content of any concrete sub-floor must be less than 80%RH (relative humidity) when tested in accordance with AS1884:2021.

If the moisture content is higher, an appropriate liquid damp proof layer can be applied, according to the adhesive manufacturer's instructions. Always measure, record and keep your test results. First repair major surface imperfections and large cracks with an appropriate repair compound or sand the screed or anhydrite if required. Sweep and vacuum to remove all debris.

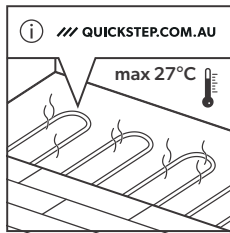

9

Additional instructions apply if there is underfloor heating. For health and safety reasons and to avoid problems with the Quick-Step floor, certain important basic rules need to be followed:

Floor Heating

- It is very important to ensure that the maximum, operational, interface temperature, at the underside of the installed flooring does not exceed 27°C.
- The glued-method gives the highest degree of heat transfer and thus ensures the optimum efficiency of your heating system. On the other hand, there is no vapor protection and there is a risk of condensation when there are excessively rapid and/or large temperature swings. Account should also be taken of small open joints that might appear during the heating season as both, the floor and the subfloor, expand and contract.
- When using "wet system" floor heating, the screed will have expansion joints. It is also necessary to copy the expansion joints of the subfloor to the floor you want to install.
- Always change the temperature gradually (no more than $\pm 5^{\circ}\text{C}$ per day) at the start and end of a heating period.
- Finally try to avoid heat accumulation by carpets or rugs or by leaving insufficient space between furniture and the floor.
- Only in slab floor heating systems are permitted, for further information please contact the manufacturer.

Note: Subfloor expansion joints must be transposed to the Quick-Step Vinyl floor and a profile must be used.

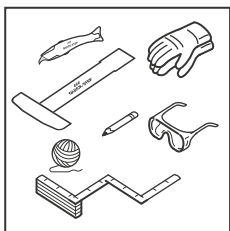

10

The following standard tools are needed: tape measure, safety glasses, cut resistant gloves, string / chalk line, a pencil. In addition to the standard tools, we recommend to use a vinyl cutter knife and installation tool. Use the recommended glue trowel to glue to ensure an even and correct distribution of vinyl glue over the subfloor.

- **Use a roller of minimum 50 Kg.**

The use of accessories other than Quick-Step Vinyl accessories may cause damage to your Quick-Step Vinyl floor. In such cases the guarantee provided by Quick-Step will be void. For this reason we advise to use only Quick-Step Vinyl accessories, which have been specially designed and tested for use with your Quick-Step Vinyl floor.

For wet applications and non-absorbant substrates another glue is needed, speak to your local adhesive supplier for best recommendation.

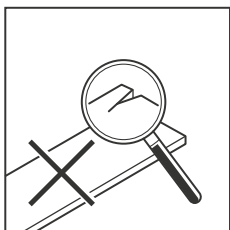
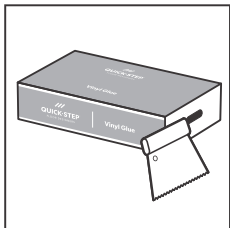

11

Check all panels before and during installation in optimal daylight conditions under the angle of light reflection. Check that the colours correspond to those ordered, the quantities are correct and there is no visible damage to the boxes. **Do not install any panels that display any obvious visible manufactured defect.**

Be aware that some designs have a natural variation within them. For defects that are visible prior to installation, Quick-Step will never assume responsibility for the uplift & relay costs.

An installed plank is considered as accepted and cannot be claimed.

2. INSTALLATION

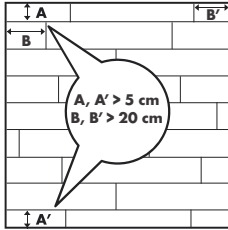

1

Before starting, carefully measure the length and the width of the room to plan a precise layout to achieve a balanced appearance of the floor.

As shown in the image, A and A' not less than 5 cm & B and B' more than 20 cm.

For Quick-Step Vinyl Pristine: A herringbone design should typically be started and maintained from a central axis. Use a chalk line or straight edge to mark the centre of your room, creating the guide line.

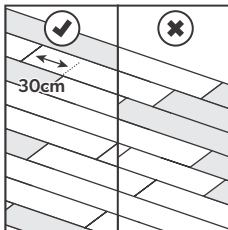

2

During installation, make sure that you mix the floor panels (and floor boxes) sufficiently so that there are not too many identical, lighter or darker planks next to each other. To obtain the best visual effect, it is best to install the panels in the direction of the longest wall and/or parallel to the incidence of light.

Install with the arrows on the underside all going the same direction.

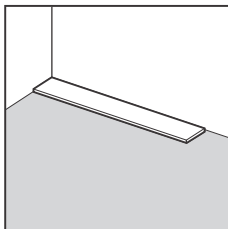

3

We recommend to dry fit first (without glue). Start the first row with a whole plank in length.

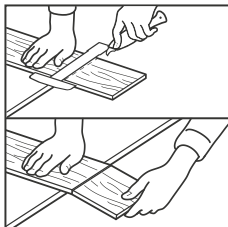

4

To shorten the length of the plank with a straight cut, you can cut the Quick-Step Vinyl floors with the decor side face up, using a special concave vinyl cutting knife. In order to cut the vinyl plank, draw a straight line along which you will be cutting, then use the knife to make a firm cut in the surface and break off the plank using both hands. You never need to completely cut through the vinyl.

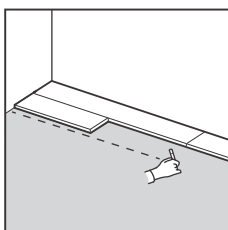

5

Draw a line along the first two dry fitted rows. This line marks to which point the glue should be applied.

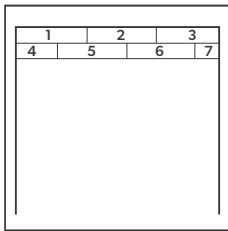
6

Now dry fit the first rows completely. **It is strongly recommended to stagger the rows by at least 30cm so that the short edge seams are not in a straight uniform line.** However you may want to try other patterns of planks to suit your taste. Make sure the first rows are on a perfectly straight line. For instance, it is possible that your starting wall has a slight angle. You can check the straightness by holding a string line (or a chalk line) and adjust the straightness of your floor where necessary. Before placing the planks in the glue, please make sure you have cut them to the right size so they neatly fit between the wall and the already installed plank.

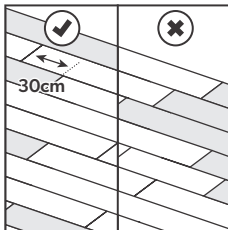

7

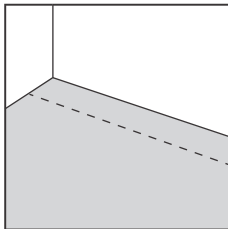
Remove the dry fitted panels.

8

Apply the Quick-Step vinyl glue on the floor between the marked line and the wall / remaining flooring. Always take into account the instructions of the vinyl glue.

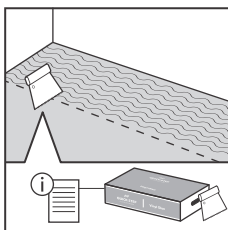
For wet applications and non-absorbant substrate another glue is needed, contact your local adhesive supplier for best recommendation.



9

Install the first two rows following the starting line. Place the planks onto the adhesive, adjust the correct position and push or roll down to ensure good adhesive transfer to the back of the planks.

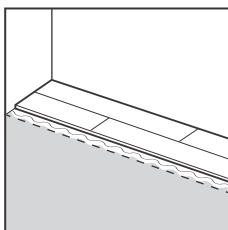
All glue residue should immediately be removed with a damp cloth. Never use detergents.

10

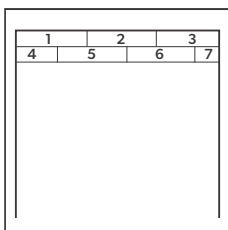
Use the same procedure to complete the rest of the room.



11

Use a heavy roll of minimum 50 Kg to ensure the best bonding and adhesive transfer.

Wait no longer than 30 minutes after placing the flooring into the adhesive before rolling on the installed area.

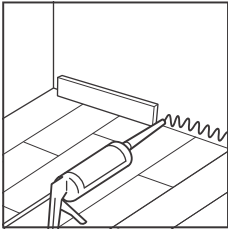

3. FINISHING



1

Inspect the final surface of the installed floor.

- For rooms with a high moisture level like bathrooms, a waterproof transparent silicone must be used at the perimeter. Follow the instructions provided by your local adhesives supplier for installation in wet areas.

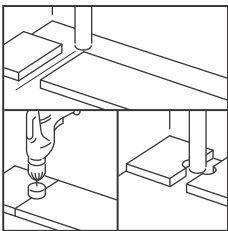

2

In rows where there is a pipe, make sure the pipe falls exactly in line with the short side of two planks. Take a drill bit with the same diameter as the pipe. Lay the planks together and drill a hole centered on the joint between the two planks. Now you can install the planks.

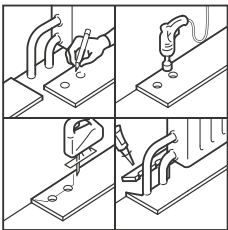

3

In case of a double pipe, drill a hole at each of the marked points that is equivalent to the diameter of the pipes.

4. MAINTENANCE

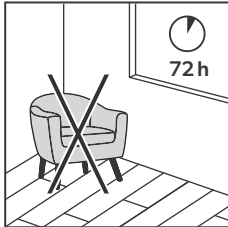

1

The glue must be able to cure 100% before moving in furniture or cleaning the floor.

Leave the floor untouched and maintain temperature between 18-30°C for the glue to completely cure, this could take up to 72 hours after installation for the curing process to complete.

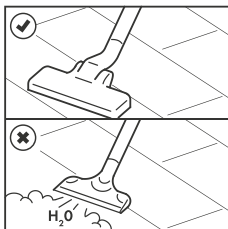

2

For dry maintenance, we advise a Quick-Step mop or vacuum cleaner equipped with soft wheels and a special brush to avoid scratches on your floor. **The use of a steam cleaner is forbidden on Quick-Step vinyl.**

Appropriate maintenance procedures will help to preserve the appearance and will extend life of a Quick-Step Vinyl floor. The frequency of maintenance will depend on the amount and type of traffic, degree of soiling, the floor colour and type.

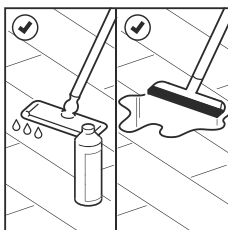

3

Your Quick-Step Vinyl floor can be cleaned with a damp or wet mop. Quick-Step Cleaner is a maintenance product specifically developed to keep your new vinyl floor in top condition.

Never use natural soap detergents since this will leave a sticky film on the surface which will collect dust and dirt and will be difficult to remove. The same with cleaning agents containing abrasive particles, these may alter the appearance of the surface. It is always important not to overdose any cleaning agent, as this will lead to a build up of cured cleaning agent which is difficult to remove without using a vinyl stripper. **When machine washing microfiber mop heads, never use fabric softener as this will leave a residue on your floor that will be difficult, sometimes impossible to remove.**

Bad maintenance can damage your floor.

We always recommend to remove spilled liquids from the floor immediately.

For further information on how to clean and maintain your floor, please visit www.quick-step.com.au.

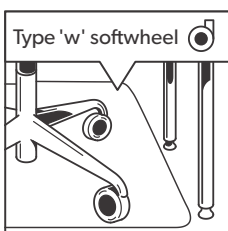

4

Protect furniture and chair legs. Use chairs type W and seats with soft wheels that are suitable for a vinyl floor and/or use a desk mat that is suitable for Quick-Step Vinyl.

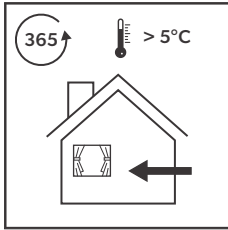

7

Ensure that the indoor climate conditions are always kept $> 5^{\circ}\text{C}$ and preferably between $18\text{-}30^{\circ}\text{C}$. It is also important to keep the subfloor in the temperature range mentioned above.

Floor Heating: It is very important to ensure that the maximum, operational, interface temperature, at the underside of the installed flooring does not exceed 27°C .

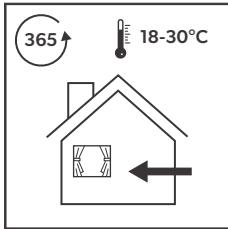

SPECIAL NOTES:

- It is recommended to avoid direct sunlight exposure as much as possible. Direct sunlight exposure may damage the floor as colour changes might occur.
- Flooring mats and furniture should be moved from time to time to avoid permanent colour changes.
- Provide furniture feet with appropriate felt protectors.
- Do not allow pets with sharp nails to walk on the floor as these nails may cause deep scratches.
- Make sure furniture legs have a large surface and are provided with non-staining felt floor protectors. The taller and/or wider the furniture feet are, the lower the 'point loading' will be on the floor and the less chance there is to damage the floor.
- Do not allow cigarettes, matches or other very hot items to contact the floor as this may cause permanent damage.
- Place **non-rubber backed mats** at outside entrances to prevent dirt, grit and soil from being tracked onto your floor. This will reduce damages, the maintenance requirement and extend the life of your floor. Prolonged contact with rubber can cause a permanent stain.

For further information please contact your local retailer or visit www.quick-step.com.au. Thank you for your purchase.